

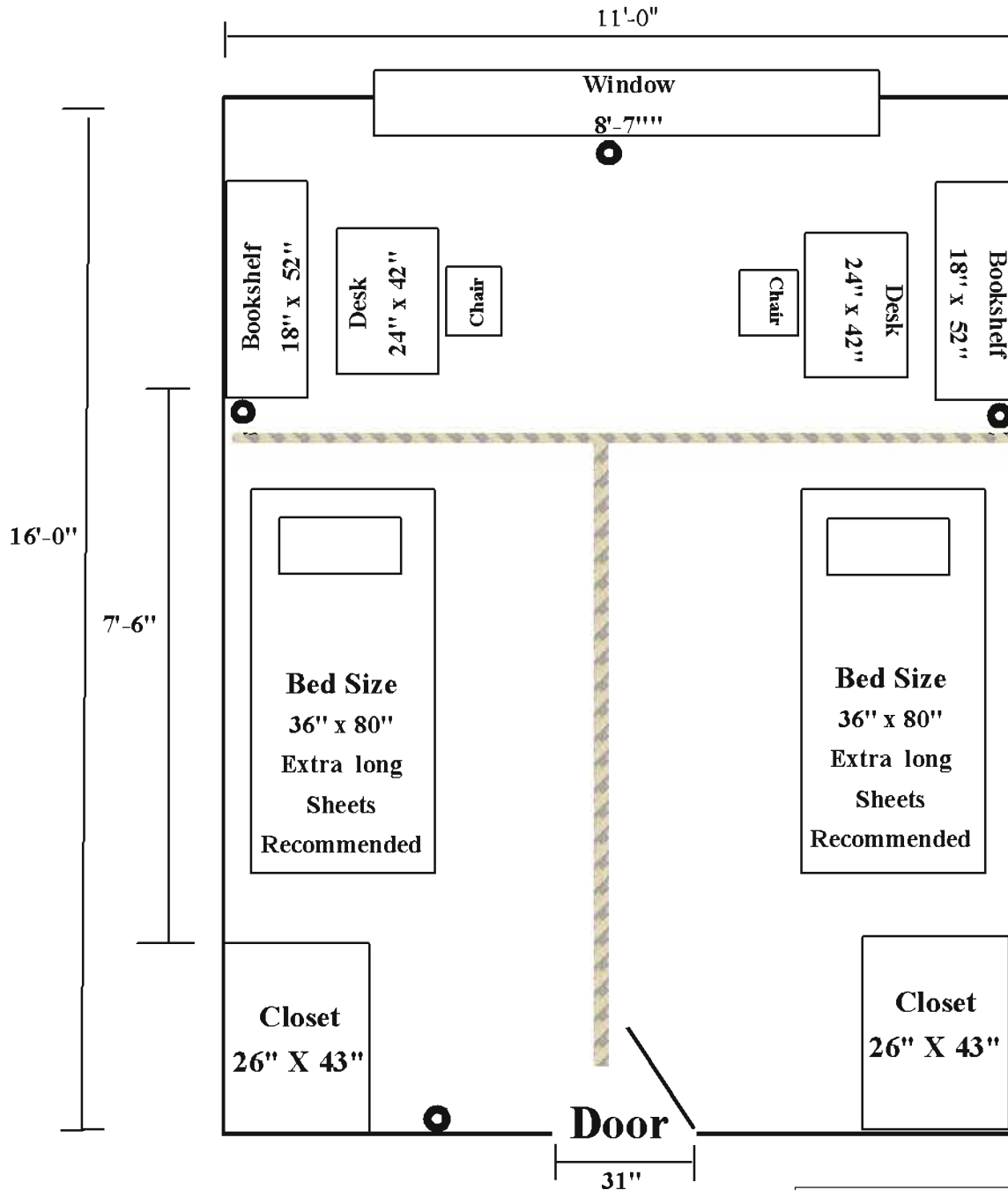

# Typical M.S.O.E Residence Hall Room



## Room Facts

Room Size 11 Feet x Feet  
 Ceiling Height 8 Feet  
 Sprinkler Pipes   
 (Lofts must clear the sprinkler heads by 18" on all sides and the pipes by 4". Pipes are 5" from the ceiling.)  
 Electrical Outlets   
 \* Sizes on this floor plan are approximate.  
 Room Sizes can vary.

## Bed Frames

Bed Frame  
3' x 6'-10"

Bed Frame  
  
 Bed Frame Leg 10.5" 4'-10" 10.5"  
 1.5"

\* Sizes on this floor plan are approximate.  
 Room Sizes can vary.